

Portable CD Player
User manual
Manuel d'utilisation
Manual del usuario

AX2411
AX2412
AX2420

Need help? Call us!
PHILIPS representatives are ready to help you with any question about your new product.
CALL US BEFORE YOU CONSIDER RETURNING THE PRODUCT!
1-888-PHILIPS(744-5477)
or visit us on the web at www.usasupport.philips.com



PHILIPS

PHILIPS CONSUMER ELECTRONICS COMPANY
Marietta, GA 30006-0026

Meet Philips at the Internet
<http://www.usasupport.philips.com>
or call
1-888-philips (744-5477)



CLASS 1
LASER PRODUCT

Be responsible
Respect copyrights

Specifications are subject to change without notice.
Trademarks are the property of Koninklijke Philips Electronics N.V.
or their respective owners.
© 2005 Koninklijke Philips Electronics N.V. All rights reserved.

Printed in China
3140 XXX XXXXX

IMPORTANT SAFETY INSTRUCTIONS

- 1. Read these instructions.
2. Keep these instructions.
3. Heed all warnings.
4. Follow all instructions.
5. Do not use this apparatus near water.
6. Clean only with a dry cloth.
7. Do not block any of the ventilation openings.
8. Do not install near any heat sources.
9. Only use attachments/accessories specified by the manufacturer.
10. Use only with a cart, stand, tripod, bracket, or table specified by the manufacturer.

EL 6475-E005: 04/01

CONSIGNES DE SÉCURITÉ IMPORTANTES

- 1. Lisez ces instructions.
2. Conservez ces instructions.
3. Respectez tous les avertissements.
4. Suivez toutes les instructions.
5. N'utilisez pas cet appareil à proximité d'une source d'eau.
6. Nettoyez l'appareil uniquement avec un chiffon sec.
7. N'obstruez aucun orifice de ventilation.
8. N'installez pas l'appareil près d'une source de chaleur.
9. Utilisez uniquement des accessoires ou options recommandés.
10. Utilisez uniquement un meuble sur roulettes.

EL 6475-F005: 04/01

INSTRUCCIONES IMPORTANTES DE SEGURIDAD

- 1. Lea estas instrucciones.
2. Conserve estas instrucciones.
3. Lea todos los avisos.
4. Siga todas las instrucciones.
5. No utilice este aparato cerca del agua.
6. Para limpiar el aparato utilice solo un trapo seco.
7. No tape las aperturas de ventilación.
8. No instale el equipo cerca de fuentes de calor.
9. Utilice exclusivamente aquellos dispositivos/accesorios recomendados por el fabricante.
10. Coloque el equipo exclusivamente sobre aquellos carros, bases, trípodes, soportes o mesas especificados.

EL 6475-S005: 04/01

Return your Product Registration Card today to get the very most from your purchase.

Registering your model with PHILIPS makes you eligible for all of the valuable benefits listed below. It's that easy. Complete and return your Product Registration Card today.

PHILIPS
Congratulations on your purchase, and welcome to the "Family".
Dear PHILIPS product owner:
Thank you for your confidence in PHILIPS. You've selected one of the best-built, best-connected products available today. We'll do everything in our power to keep you happy with your purchase for many years to come.

PHILIPS LIMITED WARRANTY ONE (1) YEAR
WARRANTY COVERAGE:
PHILIPS warranty obligation is limited to the terms set forth below.
WHO IS COVERED:
PHILIPS warrants the product to the original purchaser or the person receiving the product as a gift.

PHILIPS LIMITED WARRANTY ONE (1) YEAR
WARRANTY COVERAGE:
PHILIPS warranty obligation is limited to the terms set forth below.
WHO IS COVERED:
PHILIPS warrants the product to the original purchaser or the person receiving the product as a gift.

GARANTIE LIMITEE PHILIPS UN (1) AN
COUVERTURE DE GARANTIE:
La provision pour garanties de PHILIPS se limite aux termes énumérés ci-dessous.
QUI EST COUVERT?
PHILIPS garantit le produit au premier acheteur ou à la personne recevant le produit en cadeau.

GARANTIA LIMITADA PHILIPS UN (1) AÑO
COBERTURA DE GARANTÍA:
La obligación de la garantía PHILIPS se limita a los términos establecidos a continuación.
QUIÉNES ESTÁN CUBIERTOS:
PHILIPS garantiza el producto al comprador original o a la persona que lo recibe como regalo.

Devuelva su tarjeta de registro de producto hoy mismo y obtenga lo mejor de su compra.
Register your model with PHILIPS and you'll be eligible to receive all the valuable benefits that are included in our guarantee.
Comprobante de compra
Seguridad del producto
Beneficios adicionales de la propiedad del producto

QUICK START
1 OPEN
2 CD
3 HOLD - OFF
4 PLAY
5 VOL
6 BATT
7 BATT

English CONTROLS / POWER SUPPLY
Supplied Accessories:
1 x headphones AY3806 (for AX2411 and AX2412), AE500 (for AX2420)
CONTROLS (see figure 1):
1 HI: switches the player on, starts or pauses CD play
2 STOP: stops CD play, clears a program or switches the player off

POWER SUPPLY / GENERAL INFORMATION
Mains adapter AY3162 (not included)
Use only the AY 3162 adapter (4.5 V / 450 mA direct current, positive pole to the centre pin). Any other product may damage the player.
1 Make sure the local voltage corresponds to the power adapter's voltage.
2 Connect the power adapter to the 4.5V DC socket of the player and to the wall outlet.

GENERAL INFORMATION / CD PLAY
In-car use (not included)
Only use the AY 3545 (8822 219 10033) or AY 3548 (3140 118 71890) car voltage converter. Any other product may damage the set.
1 Put the set on a horizontal, vibration-free and stable surface. Make sure it is in a safe place, where the set is neither a danger nor an obstacle to the driver and the passengers.
2 Plug the voltage converter into the cigarette lighter socket (only for 12 V car battery, negative grounding). Then connect the wired end with 4.5V DC input socket to the set.

CD PLAY / FEATURES
Playback information
If a CD-Recordable (CD-R) or a CD-Rewritable (CD-RW) is not recorded properly, FF d 15C is displayed, indicating that the CD has not been finalized. In that case, use FINALIZE on your CD recorder to complete the recording.
When playing a CD-Recordable (CD-RW), please note that it takes 3-15 seconds after pressing ► II for sound reproduction to start.
While the CD is read, I - - - - flashes in the display.
Volume and bass
Adjust the volume by using VOLUME +/- on the CD player.

FEATURES
Programming track numbers
You can store up to 30 tracks to play in a program. A single track may be stored more than once in the program.
1 While playback is stopped, select a track with 44 01 ►.
2 Press PROG to store the track.
3 Select and store all desired tracks in this way.
4 Press ► II to start playback of your selected tracks. ► program is shown and playback starts.
You can review the program by pressing PROG for more than 2 seconds. The display shows all the stored tracks in sequence.
Notes:
- If you press PROG and there is no track selected, S.C. is displayed.
- If you try to store more than 30 tracks, F.U.L. is displayed.

FEATURES / TROUBLESHOOTING
RESUME and HOLD
You can interrupt playback and continue (even after an extended period of time) from the position where playback stopped (RESUME) and you can lock all buttons of the set so that no action will be executed (HOLD). Use the RESUME-HOLD-FF slider for these functions.
RESUME - continuing from where you have stopped
1 Switch the slider to RESUME during playback to activate RESUME.
- RESUME is shown.
2 Press ► whenever you want to stop playback.
3 Press ► II whenever you want to resume playback.
- RESUME is shown and playback continues from where you have stopped.
2 Deactivate RESUME, switch the slider to OFF.
- RESUME goes off.
HOLD - locking all buttons
You can lock the buttons of the set by switching the slider to HOLD. Now, when a button is pressed, no action will be executed. This is of use, for example, when transporting the player in a bag. With HOLD activated, you can avoid accidental activation of other functions.
1 Switch the slider to HOLD to activate HOLD.
- All buttons are locked. H.C. is shown when you press any button. If the set is switched off, H.C. is shown only when H.H. is pressed.
2 Deactivate HOLD, switch the slider to OFF.
Note: If you deactivate HOLD by switching the slider to RESUME, you will be activating the RESUME function.

Retournez rapidement votre carte d'enregistrement de garantie pour profiter pleinement de votre achat.
L'enregistrement de votre modèle auprès de PHILIPS confirme votre éligibilité à tous les bénéfices mentionnés ci-dessous. N'hésitez donc pas de remplir votre carte d'enregistrement de garantie et de nous la retourner dès que possible.
Preuve d'achat
Avis sur la sécurité des produits
Bénéfices additionnels de l'enregistrement du produit

Batteries (supplied or optionally available)
You can use the following batteries with this CD player:
normal batteries type LR6, UM3 or AA (preferably Philips), or alkaline batteries type LR6, UM3 or AA (preferably Philips).
Notes - Old and new or different types of batteries should not be combined.
- Remove batteries if they are empty or if the player is not going to be used for a long time.
Inserting batteries
1 Push OPEN ▲ to open the CD lid.
2 Open the battery compartment and insert either 2 normal or alkaline batteries.
Battery indication
The approximate power level of your batteries is shown in the display.
Battery full
Battery two-thirds full
Battery one-third full
Battery dead or empty. When the batteries are dead or empty, the symbol ☹ flashes.
b R2 b is displayed, and the beep tone sounds repeatedly.
CAUTION
Batteries contain chemical substances, so they should be disposed of properly.
Danger of explosion if battery is incorrectly replaced. Replace only with the same or equivalent type.

CD player and CD handling
Do not touch the lens (A) of the CD player.
Do not expose the unit, batteries or CDs to humidity, rain, sand or excessive heat (caused by heating equipment or direct sunlight).
You can clean the CD player with a soft, slightly dampened, lint-free cloth. Do not use any cleaning agents as they may have a corrosive effect.
To clean the CD, wipe it in a straight line from the center toward the edge using a soft, lint-free cloth. A cleaning agent may damage the CD.
Headphones AY3806 (for AX2411 and AX2412), AE500 (for AX2420)
Connect the supplied headphones to the CV/LINE OUT jack of the player.
Note: CV / LINE OUT can also be used for connecting this set to your HiFi system. To adjust the sound and volume, use the controls of the connected audio equipment and on the CD player.
IMPORTANT!
Hearing safety! Do not play your headphones at a high volume. Hearing experts advise that continuous use at high volume can permanently damage your hearing. We recommend headphones no. AY3806/AE500 for this product.
Important for models with by-passed headphones! Philips guarantees compliance with the maximum sound power of its audio players as determined by relevant regulatory bodies only with the original model of provided headphones.
In case this one needs replacement, we recommend that you contact your retailer to order a model identical to that of the original provided by Philips.
Traffic safety: Do not use headphones while driving a vehicle. It may create a hazard and it is illegal in many countries. Even if your headphones are an open-air type designed to let hear outside sounds, do not turn up the volume so high that you cannot hear what is going on around you.

Playing a CD
This CD-player can play all kinds of Audio Discs such as CD-Recordables and CD-Rewritables. Do not try to play a CD-ROM, CDi, VCD, DVD or computer CD.
1 Push the OPEN ▲ slider to open the player.
2 Insert an audio CD, printed side up, by pressing the CD onto the hub.
3 Close the player by pressing the lid down.
4 Press ► II to switch the player on and start playback.
- The current track number and elapsed playing time are displayed.
You can pause playback by pressing ► II.
- The time at which playback was paused starts flashing.
You can continue playback by pressing ► II again.
5 Press ► to stop playback.
- The total number of tracks and the total playing time of the CD are displayed.
6 Press ► again to switch the player off.
To remove the CD, hold it by its edge and press the hub gently while lifting the CD.
Note: If there is no activity, the set will automatically switch off after a while to save energy.

Selecting a track and searching
Selecting a track during playback
Briefly press 44 01 ► once or several times to skip to the current, previous or next track.
- Playback continues with the selected track, and the track's number is displayed.
Selecting a track when playback is stopped
1 Briefly press 44 01 ► once or several times to select the desired track. The track number is displayed.
2 Press ► II to start CD play.
- Playback starts with the selected track.
Searching for a passage during playback
1 Keep 44 01 ► pressed to find a particular passage in a backward or forward direction.
- Searching starts while playback continues at low volume. After 2 seconds the search speeds up.
2 Release the button when you reach the desired passage.
- Playback continues from this position.
Notes:
- If the player is in SCAN mode (see MODE chapter), searching is not possible.
- In shuffle, shuffle repeat all or repeat mode (see MODE chapter), or while playing a program, searching is only possible within the particular track.

Selecting different playing possibilities-MODE
It is possible to play tracks in random order, to repeat a single track or the entire CD, and to play the first few seconds of each track.
1 Press MODE during playback as often as required in order to activate one of the following modes. The active mode is shown in the display.
- SHUFFLE: All tracks of the CD are played in random order until all of them have been played once.
- SHUFFLE REPEAT ALL: All tracks of the CD are played repeatedly in random order.
- REPEAT: The current track is played repeatedly.
- REPEAT ALL: The entire CD is played repeatedly.
- S.C.R.A.: The first 10 seconds of each of the remaining tracks are played in sequence.
2 Playback starts in the chosen mode after 2 seconds.
3 To return to normal playback, press MODE repeatedly until the display shows no active modes.
ESP
With a conventional portable CD-player you might have experienced that the music stopped e.g. when you were jogging. The Electronic Skip Protection prevents loss of sound caused by light vibrations and shocks. Continuous playback is ensured. However ESP does not prevent playback interruptions during vigorous running. It also does not protect the unit against any damage caused by dropping!
In this set ESP is default ON. It is possible to set ESP off.
1 Press MODE/ESP for more than 3 seconds.
- ESP disappears.
2 Press MODE/ESP again for more than 3 seconds.
- ESP is displayed.
ESP on -> ESP off -> ESP on

Troubleshooting
WARNING: Under no circumstances should you try to repair the set yourself as this will invalidate the warranty. If a fault occurs, first check the points listed, before taking the unit for repair. If you are unable to solve a problem by following these hints, consult your dealer or service center.
The CD player has no power, or playback does not start
Check that your batteries are not dead or empty, that they are inserted correctly, that the contact pins are clean.
Your adapter connection may be loose. Connect it securely.
For in-car use, check that the car ignition is on. Also check player's batteries.
The indication R2 d 15C is displayed
Check that the CD is clean and correctly inserted (label-side upward).
If your lens has steamed up, wait a few minutes for this to clear.
The indication R2 d 15C is displayed
CD-RW (CD-R) is not recorded properly. Use FINALIZE on your CD-recorder.
The CD skips tracks
The CD is damaged or dirty. Replace or clean the CD.
RESUME, SHUFFLE or PROGRAM is active. Switch off whichever is on.
No sound or bad sound quality
PAUSE might be active. Press ► II.
Loose, wrong or dirty connections. Check and clean connections.
Volume might not be appropriately adjusted. Adjust the volume.
Strong magnetic fields. Check player's position and connections. Also keep away from active mobile phones.
For in-car use, check that the cassette adapter is inserted correctly, that the car cassette player's playback direction is correct (press autoreverse to change), and that the cigarette lighter jack is clean. Allow time for temperature change.

Canada
English
This digital apparatus does not exceed the Class B limits for radio noise emissions from digital apparatus set out in the Radio Interference Regulations of the Canadian Department of Communications.
Français
Cet appareil numérique n'émet pas de bruits radioélectriques dépassant les limites applicables aux appareils numériques de Classe B prescrites dans le Règlement sur le Bruillage Radioélectrique édicté par le Ministère des Communications du Canada.

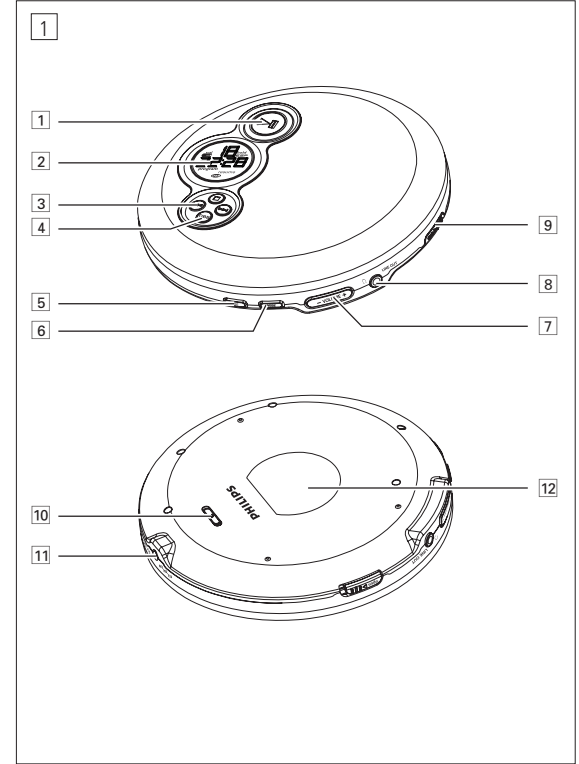

MISE EN SERVICE RAPIDE

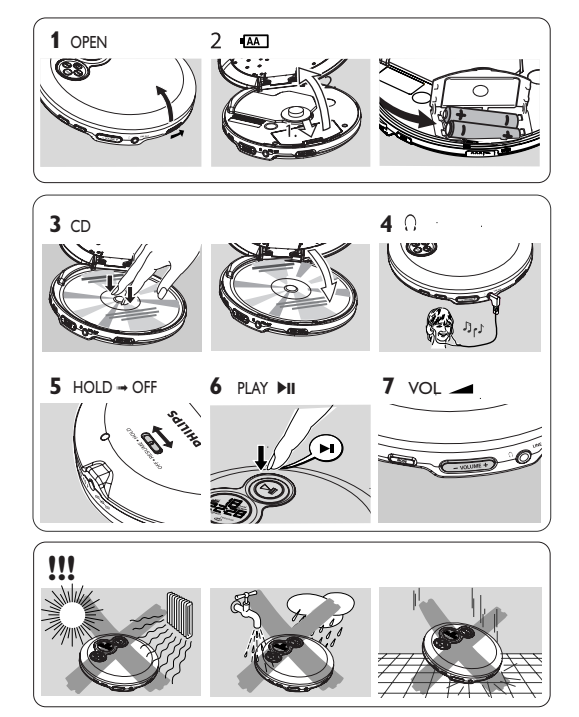

Disposal of your old product

Your product is designed and manufactured with high quality materials and components, which can be recycled and reused. When this crossed-out wheeled bin symbol is attached to a product it means the product is covered by the European Directive 2002/96/EC...

Pilas (incluidas o disponibles de forma opcional)

Con este equipo puede utilizar pilas normales de tipo LR6, UM3 o AA (preferentemente, Philips) o pilas alcalinas tipo LR6, UM3 o AA (preferentemente, Philips). Nota: No deben utilizarse mezcladas pilas nuevas con pilas usadas ni de tipos diferentes...

ATENCIÓN Al desahucarse de las pilas, hágalo con precaución, ya que éstas contienen sustancias químicas peligrosas. Si la batería se sustituye de forma incorrecta, podría producirse una explosión...

Table with 2 columns: Français and COMMANDES / ALIMENTATION ELECTRIQUE. Lists controls and their functions in French.

Table with 2 columns: Piles (fournies ou disponibles en option) and Mise en place des piles. Provides instructions for battery use and replacement.

Table with 2 columns: Español and CONTROLES / ALIMENTACIÓN ELÉCTRICA. Lists controls and their functions in Spanish.

Table with 2 columns: Manejo del reproductor de CD y de los CDs. Provides instructions for CD player operation.

Table with 2 columns: ALIMENTATION ELECTRIQUE / INFORMATIONS GENERALES and Bloc d'alimentation (non fournies). Provides electrical specifications and safety warnings.

Table with 2 columns: Lecteur de CD et manipulation des CD. Provides instructions for CD handling and playback.

Table with 2 columns: ALIMENTACIÓN ELÉCTRICA / INFORMACIÓN GENERAL and Adaptador de red (no incluidos). Provides electrical specifications and safety warnings.

Table with 2 columns: Auriculares AY3806 (para el modelo AX2411, AX2412 solamente) y A5500 (para el modelo AX2420 solamente). Provides instructions for earphone use.

Table with 2 columns: INFORMATIONS GENERALES / LECTURE CD and Utilisation en voiture (non fournies). Provides general information and car usage instructions.

Table with 2 columns: Ecouteurs AY3806 (uniquement pour le modèle AX2411 et AX2412), A5500 (uniquement pour le modèle AX2420). Provides instructions for earphone use.

Table with 2 columns: INFORMACIÓN GENERAL / REPRODUCCIÓN DE UN CD and Utilización en el automóvil (no incluidas). Provides general information and car usage instructions.

Table with 2 columns: Reproducción de un CD. Provides instructions for CD reproduction.

Table with 2 columns: LECTURE CD / CARACTERISTIQUES and Informations relatives à la lecture. Provides information about CD playback and characteristics.

Table with 2 columns: LECTURE CD / CARACTERISTIQUES and Informations relatives à la lecture. Provides information about CD playback and characteristics.

Table with 2 columns: REPRODUCCIÓN DE UN CD / CARACTERÍSTICAS and Información acerca de las reproducciones. Provides information about CD reproduction and characteristics.

Table with 2 columns: Selección de una pista y búsqueda. Provides instructions for track selection and search.

Table with 2 columns: CARACTERISTIQUES and Programmation des numéros de pistes. Provides information about track programming and features.

Table with 2 columns: CARACTERISTIQUES and Programmation des numéros de pistes. Provides information about track programming and features.

Table with 2 columns: CARACTERÍSTICAS and Programación de números de pista. Provides information about track programming and features.

Table with 2 columns: Selección de las distintas posibilidades de reproducción - MODE. Provides instructions for different playback modes.

Table with 2 columns: CARACTERISTIQUES/PANNEST ET REMEDES and RESUME et HOLD. Provides information about features and troubleshooting.

Table with 2 columns: CARACTERISTIQUES/PANNEST ET REMEDES and RESUME et HOLD. Provides information about features and troubleshooting.

Table with 2 columns: CARACTERÍSTICAS/SOLUCIÓN DE PROBLEMAS and RESUME y HOLD. Provides information about features and troubleshooting.

Table with 2 columns: Solución de problemas. Provides troubleshooting instructions.

Table with 2 columns: Mise au rebut de votre ancien produit and Remarque. Provides disposal instructions and notes.

Table with 2 columns: Pannes et remèdes. Provides troubleshooting instructions.

Table with 2 columns: Desecho del producto antiguo and Remarque. Provides disposal instructions and notes.

Table with 2 columns: Solución de problemas. Provides troubleshooting instructions.